

5

ADDED SSH AND SSR PANEL WIDTHS

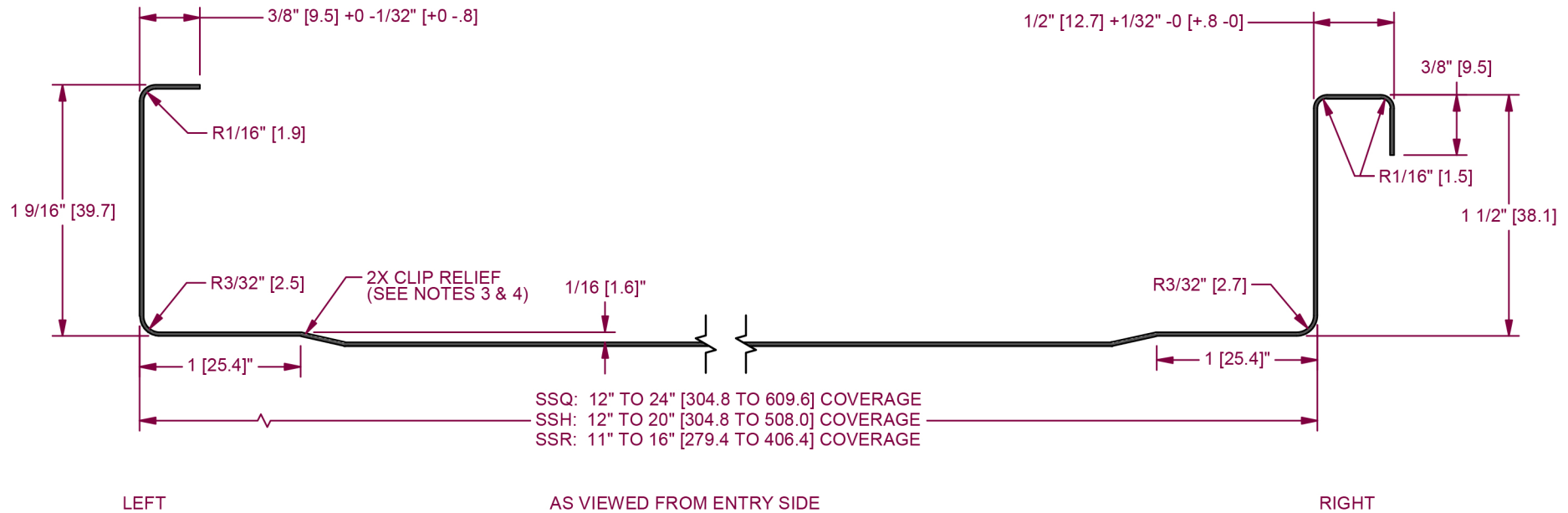
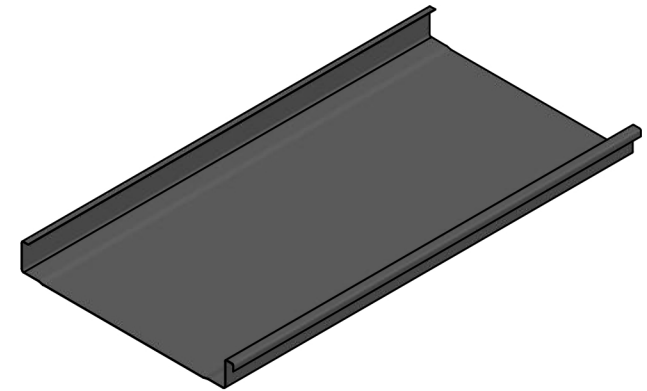

- NOTES:
1. MATERIAL USAGE: APPROX. 4" [101.6] APPROX.
 2. CLIP RELIEF ROLLERS ARE STANDARD WITH THIS PANEL.
 3. PANEL IS SHOWN WITH CLIP RELIEF ROLLERS ENGAGED.
 4. OPTIONAL MINOR BEAD RIB OR STRIATIONS AVAILABLE.
 5. DUAL DIMENSIONS: Inch [mm]

REVISION HISTORY		MATERIAL PAINTED STEEL/PAINTED ALUMINUM/COPPER			FINISH NONE		TOLERANCES	
REV	ECR NO.	DATE	RELEASED BY					
1	ADDED R DIM	07/02/2009	JD			.XX = ± .01		
2	ADDED TOL.	07/22/2011	JD			.XXX = ± .005		
3	LEG WAS 1"	05/02/2012	JD			FRACTION = ± 1/32"		
4	R-2190					ANGLE = ± 1/2'		
5	R-2368	6/11/2020	AJB					

		SS150 PANEL PROFILE	
DRAWN BY Jim DATE 06/26/2002	PART NAME SS150 PANEL PROFILE	CHECK BY JD DATE 01/17/2008	PART NUMBER SP5-150P
SHEET 1 OF 1		REVISION 5	